

# Quick start



Refer to safety guidelines in the user manual  
before operating your Dyson vacuum cleaner.

**DC**  
**24**

## Assembling your Dyson cleaner

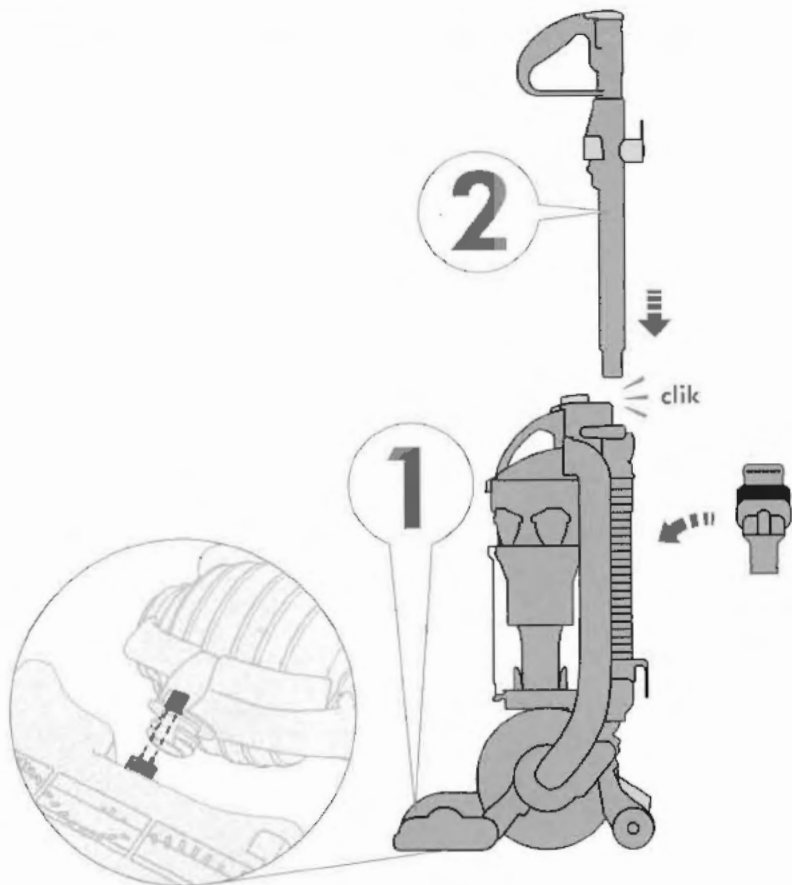

## Using your Dyson cleaner

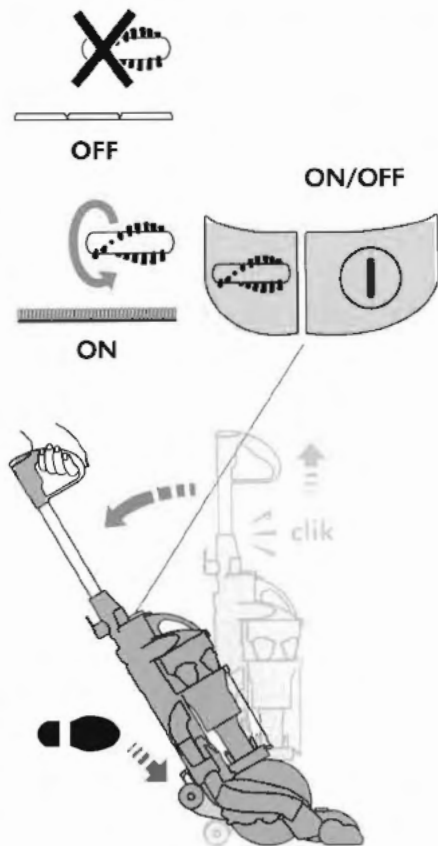

## High-reach cleaning

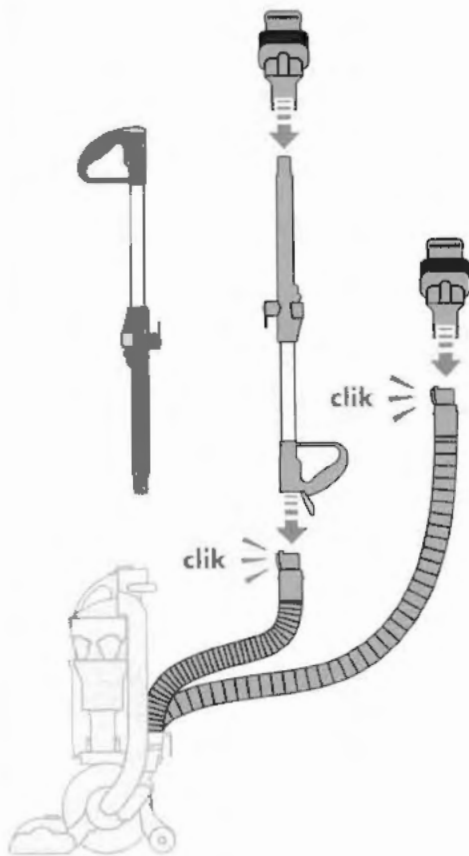

# Clear bin™ emptying

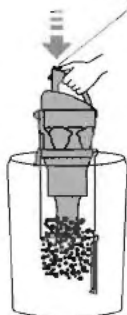
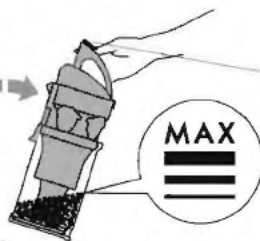
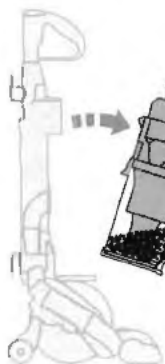

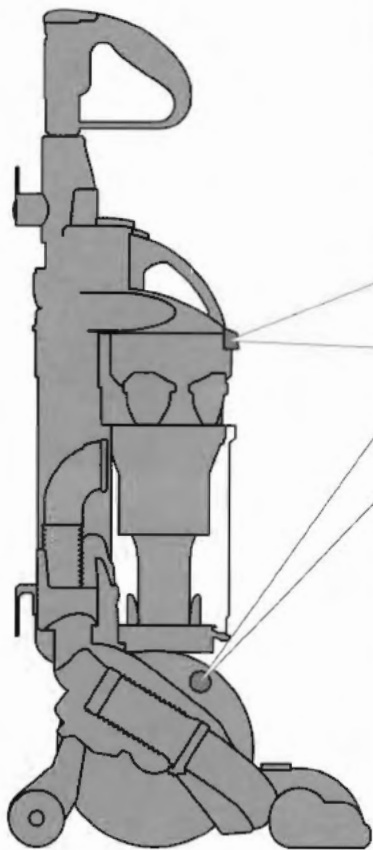

## REMEMBER

Wash filters **A** and **B**  
with cold water at least  
**every month.**

## IMPORTANT!

Refer to user manual for  
washing instructions.

Free filter wash reminder service:  
[www.dyson.co.uk/filterwash](http://www.dyson.co.uk/filterwash)